

repose[®]
ultracore[®]

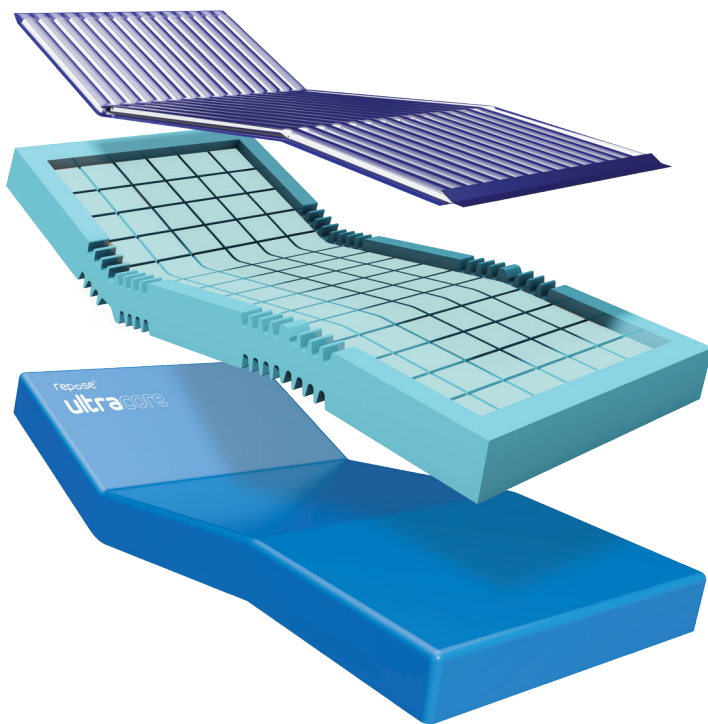

instructions for use

www.easycare systems.co.uk

repose[®]
ultracore[®]

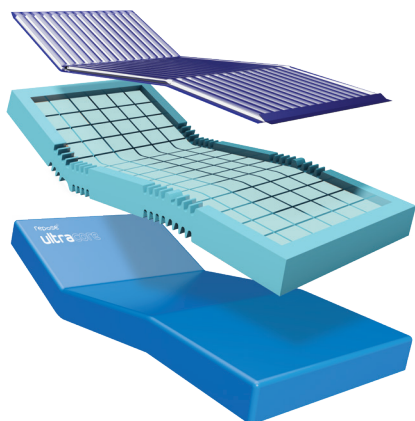

repose[®]
ultracore[®]
plus

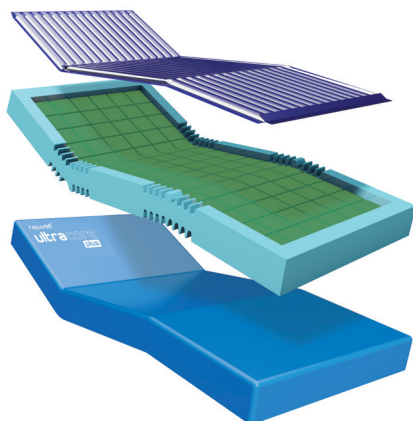

PRODUCT SPECIFICATION

Product	Foam Density / Hardness		Dimensions (cm)		
	Support Surface	Walls	Width	Height	Length
Repose[®] ultracore[®]	33 / 120	39 / 200	88	15	198
Repose ultracore plus	33 / 160	39 / 200	88	15	198

This user manual contains important information on the correct usage, handling, cleaning and decontamination. Please read carefully prior to use.

! IMPORTANT Indicates a hazardous situation that could result in damage to property if it is not avoided.

PRODUCT DESCRIPTION

Repose® ultracore® is an immersive, static air, polyurethane foam hybrid mattress, designed to meet the demands of the home care and acute care healthcare environments.

Repose ultracore combines several different components that when combined, provide healthcare professionals and patients exceptional levels of comfort and pressure redistribution properties. At its core, is the Repose mattress overlay, which has over 18 years of clinical evidence to support its ease of use and durability.

Repose ultracore mattress consists of the following components:

- **Repose ultracore** - A high specification, polyurethane foam U-core base with integrated side and a base profiling
- **Repose ultracore overlay** - A single air cell responsive mattress made from thermoplastic polyurethane, which is multi-stretch and moisture vapour permeable
- **Repose ultracore cover** – A multi-stretch, moisture vapour permeable cover, with zip openings on three sides, including a protective zip cover and welded seams, to provide fluid ingress resistance

INDICATIONS FOR USE

Repose ultracore mattress is designed for the prevention and treatment of pressure ulcers and is intended to be used in conjunction with an appropriately sized bed frame, as part of a pressure ulcer prevention program.

Repose ultracore mattress is designed to be cleaned and reused.



PRECAUTIONS

Repose ultracore mattress is not suitable for the following:

- Must not be used on a double bed mattress frame
- Not for persons weighing in excess of 222 kg / 35 stone
- Not for persons with unstable spinal fractures
- Avoid direct contact with heat and sharp objects
- Keep away from pets
- Where body shape is such that the person cannot be fully supported

PRODUCT LABELLING



65°C for 10 minutes or
73°C for 3 minutes



Bleaching agent
allowed



Max user weight



Do not pierce or cut



Latex free



Do not put near flame

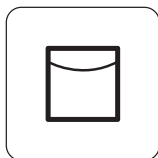

Line dry

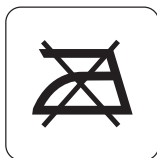

Do not iron



CE conform



Refer to user manual

USER INSTRUCTIONS

! IMPORTANT To aid storage and handling, this ultracore mattress has been delivered compact rolled. The mattress should be unrolled within 21 days of receipt. Once unrolled open the mattress cover and place the inflatable Repose ultracore inner overlay, clear side up inside the foam surround.

- Push umbilical through hole at either end
- Orientate the cover with the umbilical

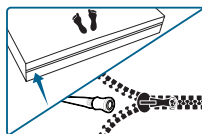

Release the zip to gain access to the
Repose umbilical Tube

STORAGE & CARE

Mattresses should be stored in a secure location away from the general public.

- Never store other items on top of ultracore
- Always store ultracore flat
- Do not store directly on the floor
- Place a protective covering over ultracore during storage
- Do not store mattresses next to radiators or other heating devices
- It is recommended that the ultracore is handled by a minimum of two people. Do not drag!
- Do not place heavy objects on the mattress surface when not in use
- Do not allow sharp objects to penetrate the cover
- Regularly inspect the interior and exterior of the mattress
- Do not store in damp conditions

! IMPORTANT When removing packaging use great care to ensure the cover is not damaged.

Repose ultracore can be used one hour after unrolling. However, it may take longer before the mattress is fully restored to its original shape.

! IMPORTANT Please ensure that once unrolled the cover seams sit correctly to the edges of the foam mattress and that the zip is fully closed before use. Some seam slippage may occur in the rolling process but can easily be realigned over the mattress core.

Some degree of creasing may occur to the mattress cover; this is a normal result of the rolling process.

! IMPORTANT It is recommended that 2 people lift / carry the mattress. Mattresses can become damaged when stored incorrectly.

Repose ultracore mattress has been designed for use on solid, mesh, profiling and flatbed bases, for patients identified as being at high risk of developing a pressure ulcer, with a maximum weight of 222 Kg / 35 stone.

Ensure that the surface of the bed frame is clear from debris before placing the mattress as this can damage the coating of the cover.

The cover on the ultracore is removable for cleaning purposes, Please see section 'Cleaning & Care'.

The label on the mattress has a unique batch number which should be retained and used in the event of a warranty claim. NEVER remove the label, please refer to the section 'Warranty'.

REPOSE INNER MATTRESS PUMP UMBILICAL LOCATION



The repose mattress umbilical is located inside the outer cover, bottom left hand corner as you stand at the foot of the bed. For inflating & checking of internal pressure.

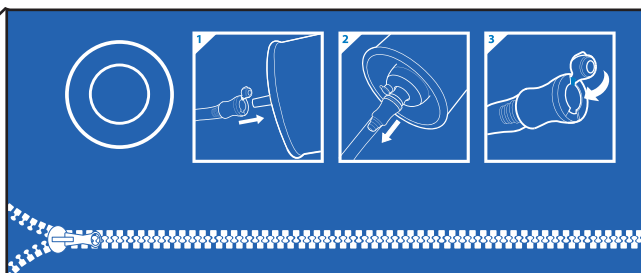

INSTRUCTIONS FOR USE

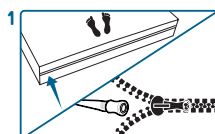

Release the zip to gain access to the Repose umbilical Tube

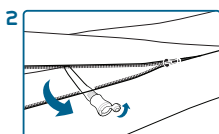

Release umbilical connection cap

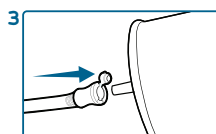

Connect pump nozzle to umbilical tube



Inflate the Repose Ultracore Mattress until air is heard escaping from the pump valve followed by an audible click

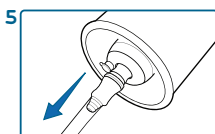

Remove pump from umbilical connector

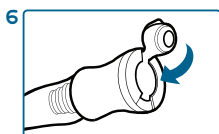

Replace umbilical connection cap

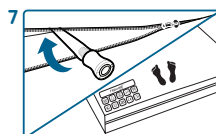

Replace umbilical tube back inside the cover and close zip

NOTE: Check device daily to ensure proper inflation level. In case of doubt, repeat pumping procedures above with the user off the product.

CLEANING & CARE – REPOSE ULTRACORE COVER

LIGHT SOILING

! IMPORTANT In the absence of gross contamination or unusual risk. The removal of dirt and spillages with a neutral detergent and warm water should be sufficient. However, if required the cover can be wiped down with a 0.1% hypochlorite solution (1000ppm). Ensure that the cover is rinsed with clean water using a single use non-abrasive cloth, and thoroughly dried. Ensure adequate ventilation.

HEAVY SOILING

! IMPORTANT In cases of gross contamination the mattress cover should be cleaned first with detergent and water and then with a diluted solution of 0.1% hypochlorite (1,000ppm). Rinse well with clean water and wipe down with a damp single use non-abrasive cloth, and thoroughly dried. Ensure adequate ventilation.

! IMPORTANT If required, a 1% hypochlorite solution (10,000ppm) and cold water may be applied for no more than 2 minutes.

! IMPORTANT Machine washing instruction for outer mattress cover.

Disinfection may be achieved by laundering at temperatures not exceeding 65°C for 10 minutes or 73°C for 3 minutes. **Protect, Rinse and Dry -BHTA guidance on the care, cleaning and inspection of healthcare mattresses. (January 2012 - HHTA HM 0112)**

DRYING

! IMPORTANT To avoid shrinkage, line dry in an indoor clean environment. Covers must be thoroughly dried before re-fitting to the mattress.

! IMPORTANT Do not mangle or iron.

INSPECTION

WARNING:

Inspect the inner and outer surfaces of covers and their zip fasteners regularly for signs of damage. If the cover is stained, soiled or torn, the foam and Repose core should be examined. Damaged / soiled covers and mattresses should be reported to the ward / department manager. If the core of the mattress is wet or badly stained, the mattress should be withdrawn from service.

CLEANING & CARE – REPOSE ULTRACORE OVERLAY

- Repose ultracore overlay can be cleaned with soap or detergent and water and can be disinfected in accordance with **Protect, Rinse and Dry -BHTA guidance on the care, cleaning and inspection of healthcare mattresses. (January 2012 - HHTA HM 0112)**
- Alcohol & phenol based disinfectants should not be used
- Allow to dry before re-use or storage

! IMPORTANT Disposable gloves and aprons should be worn. As splashing could occur, it is recommended that eye / face protection should also be worn. On removal of gloves, hands should be washed. Ensure Repose ultracore overlay is thoroughly dried before placing back inside the cover.

AUDIT

! IMPORTANT It is recommended that a 6 monthly or annual audit of all mattresses within a ward / department should be performed.

In the homecare setting, an audit should also be performed between each change of patient.

RE-USE

! IMPORTANT A cleaning record should be kept. The product is suitable for repeated use. Before re-use, clean the product thoroughly, please refer to the section `Cleaning & Care`.

DISPOSAL

! IMPORTANT The disposal and recycling of used product and packaging must comply with the applicable legal regulation in each country.

CPR MODE

CPR should be carried out on a hard surface for correct compression and depth of compression, if the patient needs intervention this should not be delayed, but if possible PAT slide or moving a patient to a hard surface should be advised.

FIRE TESTING

The interior foams meet the requirements of The Furniture & Furnishings (Fire) (Safety) Regulations 1988.

1. UK specification ultracore mattress meets the requirements of BS 7177: 2008 for medium hazards
2. European specification ultracore mattress meets the requirements of BS EN 597-1: 1995 / BS EN 597-2: 1995

WARRANTY

Repose ultracore warranty is valid from time of shipping. If a defect or fault is discovered, please contact Repose customer service on Tel: 0044 (0) 1495 235800 / email: info@reposedirect.com immediately. Frontier Medical Group will not accept responsibility for damage caused by misuse or non-observance of the instructions set out in this instruction for use document. During the period of the warranty, any products that have become defective due to faulty workmanship or materials will be renewed. Product warranty will be forfeited should any unauthorized alteration be made to the equipment. Both warranty and fire retardancy certification will be null and void if non-Repose spares are used on any Repose ultracore mattress products.

WARRANTY – FOAM & OUTER COVER

- 5 years from date of dispatch, covering against manufacturers defects
 - Normal wear and tear would not be included
 - All warranties subject to terms and conditions of trading
 - Warranty claims must be accompanied with appropriate batch numbers which can be found printed on the product labels
-

WARRANTY - INNER REPOSE MATTRESS OVERLAY

- 3 years from date of dispatch, covering against manufacturers defects
- Normal wear and tear would not be included
- All warranties subject to terms and conditions of trading
- Warranty claims must be accompanied with appropriate batch numbers which can be found printed on the product labels



For more information:

Units 5 and 6 Lower Vicarage Road Southampton

Hampshire

SO19 7RJ

T: 02380 420678

E: info@easycareystems.co.uk

Special Products and Service