

Prism General Purpose Clip Sling



PRISM MEDICAL UK

Size Guidance with reference to existing Arjo® Slings

Prism Sizing	Arjo® Sizing	Colour Ref	Prism Polyslip Code	Prism Black Spacer Code
Small	Small	Red	8U1540	8U4540
Medium	Medium	Yellow	8U1440	8U4440
Large	Large	Green	8U1340	8U4340
X Large	Large Large	Purple	8U1240	8U4240
XX Large	X Large	Blue	8U1140	8U4140

The Prism General Purpose Clip Sling has been designed to be used on stud style carry bars and are suitable replacement slings for the Arjo® range of slings but with the benefits of the Prism design.

- Slipfit material to the exterior of the leg sections to aid fitting (Polyslip Only)
- Binding removed from the outer edge of the leg section for increased comfort.

The size of the Prism sling is distinguished by the colour of the pull strap on the attachment clips and matches the colour coding used by the Arjo® range.

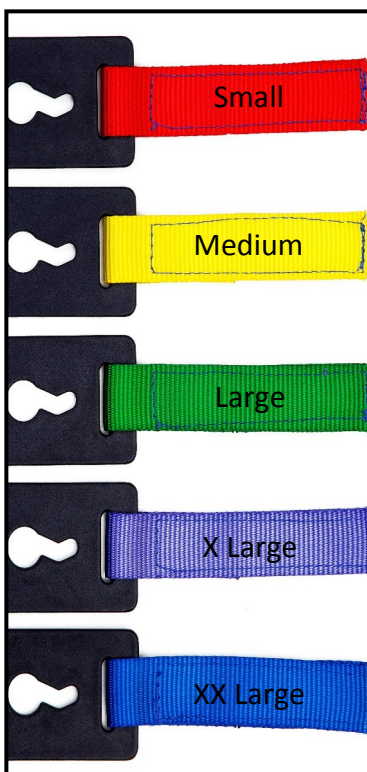

Sling Dimensions

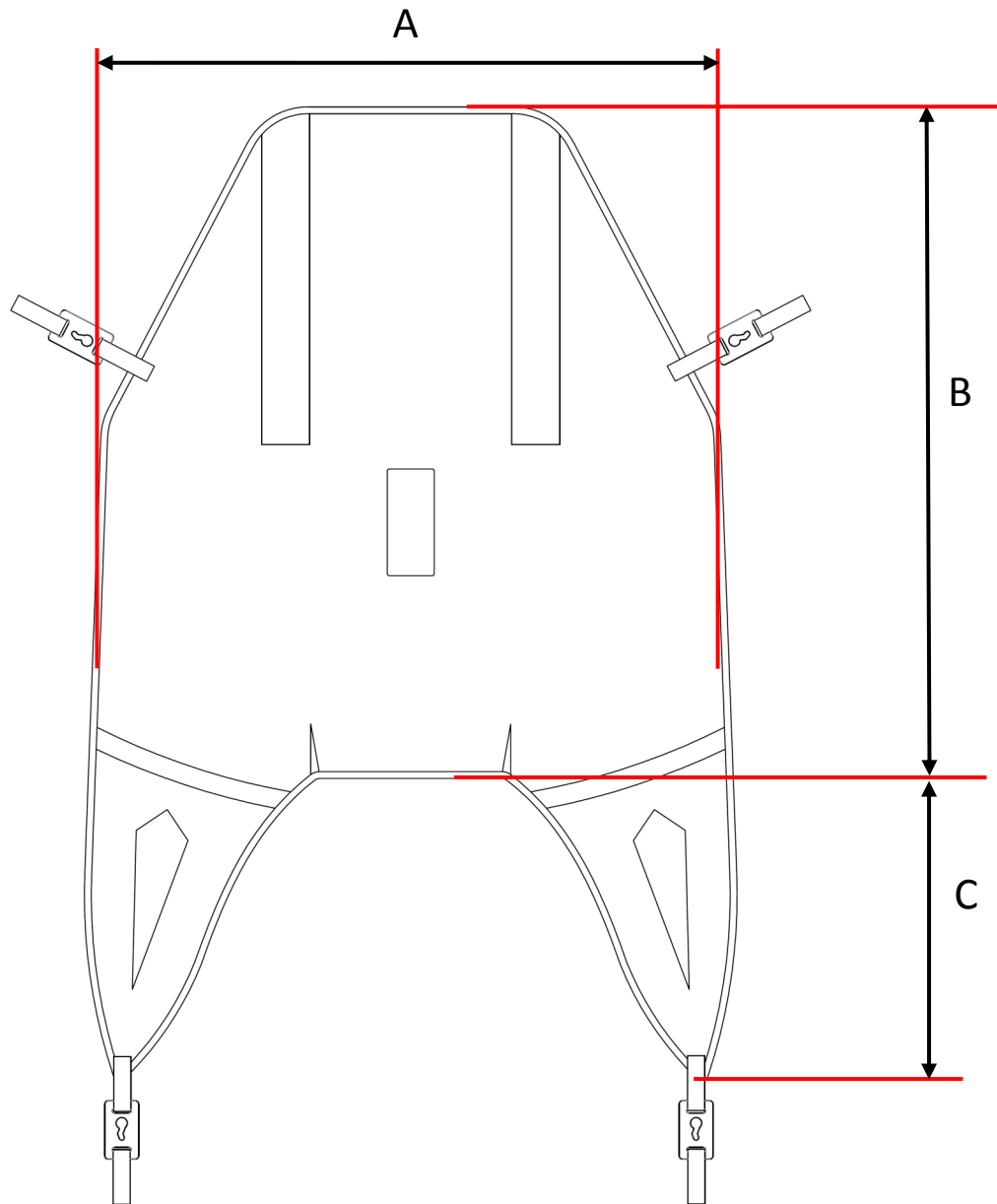

	A	B	C
Small	850	820	420
Medium	950	880	440
Large	1000	940	460
X Large	1050	1000	480
XXL	1100	1050	500

All dimensions have a tolerance of +/- 20mm
Prism General Purpose Clip Sling

Application

ONLY TO BE USED WITH STUD TYPE CARRY BARS

The Prism General Purpose Clip Sling is designed for ease of fitting and general purpose transfer. It can be used to transfer from the seated to recumbent position or from recumbent to seated. The person must be assessed by a competent person who must be fully trained in the suitability, application and fitting of the sling. Carers should always be trained in the use of hoists and slings.

Prior to use of the sling, the following instructions must be read and adhered to as well as the instructions for the hoist to which the sling is to be attached.

The plastic stiffeners supplied with the sling **MUST** be placed in the head support pockets prior to use.

Sling Inspection

All Prism Slings are manufactured to meet and exceed the requirements of BS EN 10535:2006 'Hoists for the transfer of disabled persons– Requirements and test methods'. Slings should be inspected prior to use and after washing. Damaged or badly worn slings should be discarded... The label on the sling contains vital information to identify the sling - if any part of the label becomes illegible, then it must be removed from service and replaced.

The sling should be visually inspected with regard to the following items:-

- Any signs of damage (i.e. cuts, frays, tears, burns) to the sling straps
- Any sign of damage to the plastic attachment clips.
- Any signs of stitching becoming undone on any part of the sling
- Any signs of the fabric being stretched, tearing or undue wear
- Any signs of discolouring or bleaching on the material
- Is the sling complete? i.e. all straps present, stiffeners in place - where applicable, etc
- Label clearly legible

Maximum Load (Safe Working Load - SWL)

The maximum load for the sling is clearly marked on the label of the sling. The maximum load will also be displayed on the hoist and any detachable elements of the hoisting system.

DO NOT exceed the maximum load stated on any of the equipment.

How to attach the clips to the carry bar

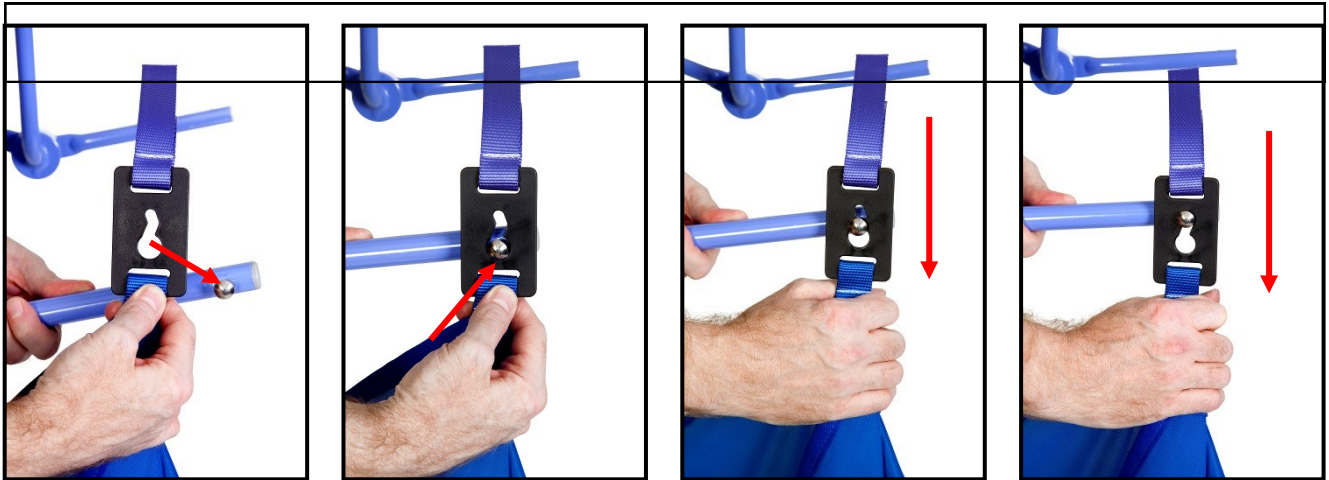

Repeat the four steps above for each of the attachment clips.
Ensure that all clips are secure in the most downward position before commencing the lift.

How to remove the clips from the carry bar

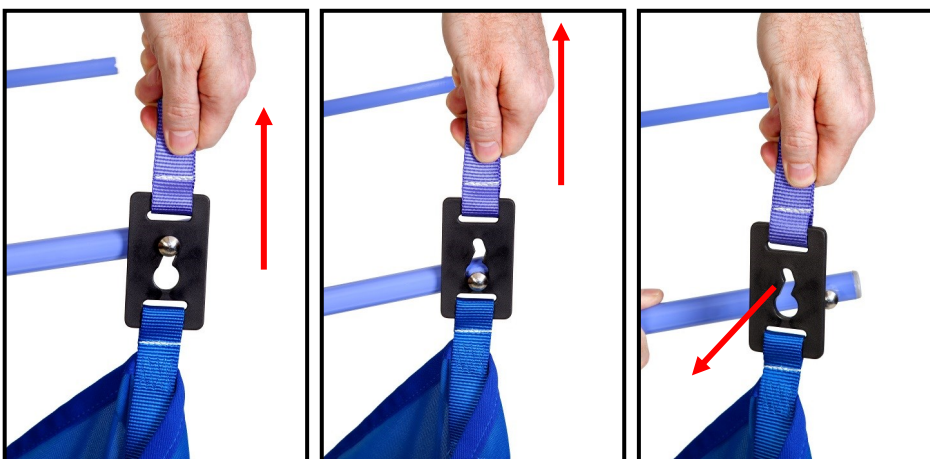

DO NOT USE
on carry bars with
Hook attachments



Prism General Purpose Clip Sling - Material Variants / Uses

Polyslip:

The sling is made from a close knit polyester material and has nylon 'rip stop' material to the outer side of the leg sections to aid the fitting of the sling. This is a General Purpose Clip Sling and can be used for sitting and recumbent transfers between chairs, beds, floor, baths, changing beds, WC's etc.

Spacer:

The sling is made from knitted polyester "spacer" fabric that is manufactured with an 'air gap' internally. The material stretches slightly in all directions and moulds perfectly to the shape of the person being hoisted. This is a General Purpose Clip Sling that can be used as the Poly, but has the added benefit of being suitable to be left in position if required *.

